

KS Series Quick Coupling



Features :

For general purpose, medium pressure.

- Two-way shut-off with an automatic shut-off valve incorporated into both the socket and the plug.
- Automatic shut-off valves in socket and plug provide an instant, perfect seal when coupling is disconnected.
- Packing be selected according to fluid type.
- Highly accurate machining technology creates an extremely tight seal.
- Designed for a wide variety of applications.

Applications :

Material Recommended Fluids Applications

Stainless steel 304 Acid, alkali, salty water

- Water piping, sea water
- Oxygen, acetylene
- Steam piping
- Chemicals, chemical plants
- High-pressure gas (N², Freon, etc)

Specifications :

Material	Stainless steel
Size 1/4", 3/8" 1/2", 3/4", 1" 1 1/4", 1 1/2"	" 2"
Working pressure (kg/cm ²) 75 45 30 20	
Maximum pressure (kg/cm ²) 100 65 45 30	
Packing material and operating temperature	Nitrile butadiene rubber -10°C ~ +80°C Optional Viton -10°C ~ +180°C Standard Material
Type of connection	Female thread for both socket and plug

Structure :

When disconnected.....

The socket and plug valves seal instantly, automatically shutting off fluid flow to prevent leakage.

When connected

The socket and plug valves push together, opening to permit free flow of fluid through coupling. An O-ring in the socket seals the plug surface preventing any leakage.

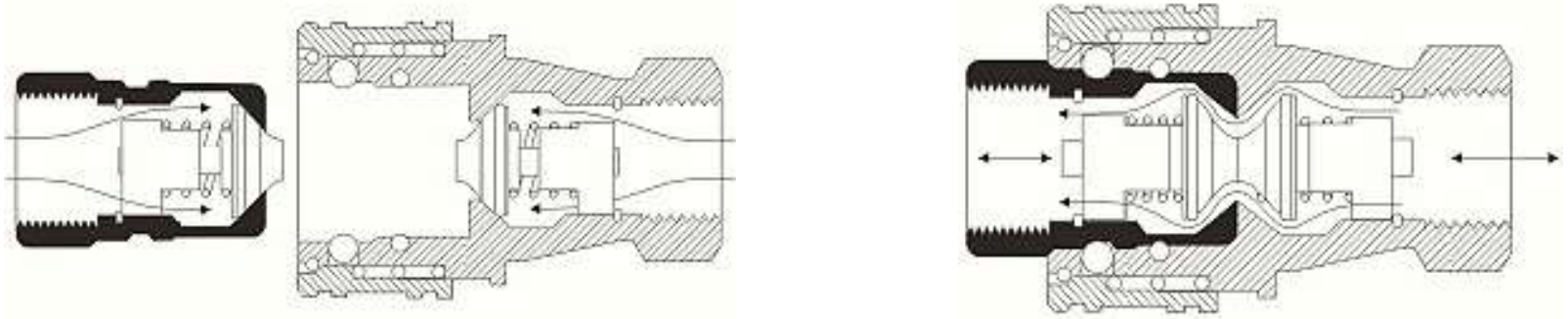

Interchangeability :

Different size sockets and plugs are not interchangeable.



Precaution :

- Select packing material in accordance with the type and temperature of fluid.
- Dust, foreign matter and flaws may cause leakage.

Dimensions :

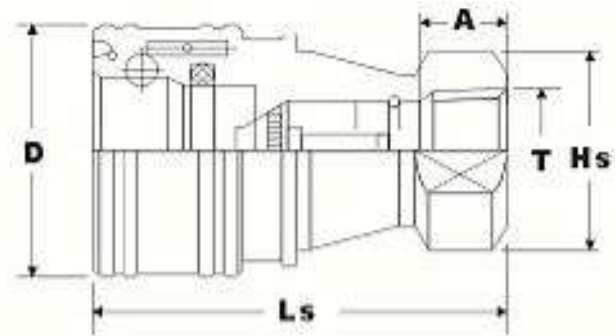

Socket

Part No.	Size	Ls	D	A	Hs	T
KS-2S	1/4 PT	58	28	14	2Hex.	17*22 f 1/4 PE-PT
KS-3S	3/8 PT	65	35	15	2Hex.	22*25 f 3/8 PE-PT
KS-4S	1/2 PT	72	45	15	2Hex.	26*32 f 1/2 PE-PT
KS-6S	3/4 PT	90	55	19	2Hex.	33*39 f 3/4 PE-PT
KS-8S	1" PT	102	65	20	2Hex.	41*48 f 1" PE-PT
KS-10S	1 1/4" PT	115	77.5	24	2Hex.	54*59 f 1 1/4" PE-PT
KS-12S	1 1/2" PT	124	87.5	24	2Hex.	63*69 f 1 1/2" PE-PT
KS-16S	2" PT	132	109	27	2Hex.	77*86 f 2" PE-PT

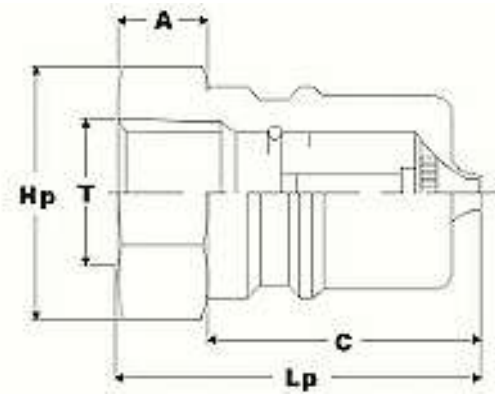

Plug

Part No. Size Ls D A Hs T

KS-2P 1/4 PT 36 22 14 Hex . 17 1/4 PE-PT

KS-3P 3/8 PT 40 25 15 Hex . 21 3/8 PE-PT

KS-4P 1/2 PT 44 28 16 Hex . 27 1/2 PE-PT

KS-6P 3/4 PT 54 36 18 Hex . 35 3/4 PE-PT

KS-8P 1" PT 62 40 20 Hex . 41 1" PE-PT

KS-10P 1 1/4" PT 70 45 24 *1Hex. 54 1 1/4" PE-PT

KS-12P 1 1/2" PT 75 49 24 *2Hex. 63 1 1/2" PE-PT

KS-16P 2" PT 80 52 27 2Hex. 77*84 f 2" PE-PT

1Stainless steel: 2hex. 54 x f 59 2 Sta inle ss steel: 2hex. 63 x f69

KURAT Enterprise

Warning for Your Safety

The system designer and user have the sole responsibility to select products suitable for their special application requirements to ensure the proper installation. Operation and maintenance of the product. Application details, material compatibility and product ratings should all be considered in the individual selection. Improper selection or use of product can cause property damage or personal injury. Kurat accepts no liability for any improper selection, installation, operation or maintenance.

NL Series Quick Coupling



Features :

- For pneumatic tool lines.
- One-way automatic shut-off valve in the socket.
- Ideal for such applications as factory air supply.
- Pneumatic tool connections, etc.
- Many types for a wide variety of applications.

Applications :

Material Recommended Fluids Applications

Stainless steel 304 Air, water Pneumatic tools, air piping,

air pressure equipment, water piping

Specifications :

Material	Stainless steel
Size 1/4"(NL22type),3/4"(NL23type),1/2"(NL24type),1/2"(NL44type), 3/4" (NL-46 type), 1" (NL-48 type)	
Working pressure (kg/cm ²)	15
Maximum pressure (kg/cm ²)	20
Packing material and operating temperature	Nitrile butadiene rubber -10°C ~ +80°C Optional Product Viton -10°C ~ +180°C Standard Material
Type of connection	Female thread for both socket and plug

Interchangeability :

- (1)All NL-22 (1/4"), NL-23(3/8"), and NL-24(1/2") model numbers are interchangeable.
- (2)All NL-44 (1/2"), NL-46(3/4"), and NL-48(1") model numbers are interchangeable.
- (1) and (2) are not interchangeable with each other.

Structure :

When disconnected
The socket valve provides an instant seal, automatically shutting off fluid flow to prevent leakage.

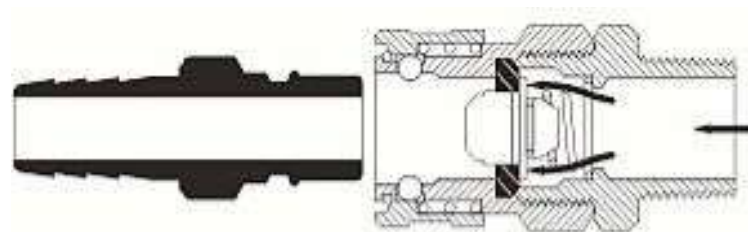

When connected
The plug and socket engage securely, fully opening valve automatically to assure maximum fluid flow.

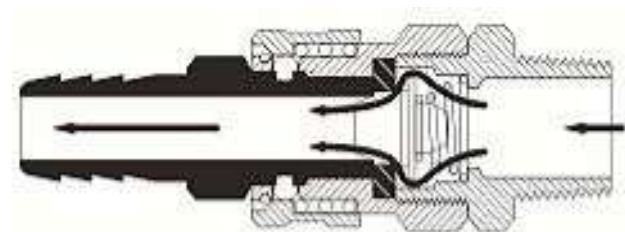

SM female thread connection

Dimensions :

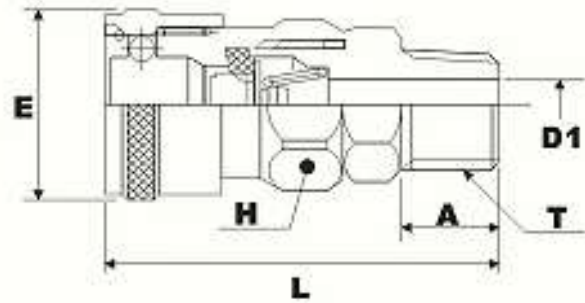

Socket

Part No. T A D1 E H L

SM-22 1/4 PT 13 8 25 19 54.5

SM-23 3/8 PT 14 9 25 19 55.5

SM-24 1/2 PT 17 9 25 21 59

SM-44 1/2 PT 17 12 35.5 30 65

SM-46 3/4 PT 19 16 35.5 30 67

SM-48 1" PT 22 18 35.5 35 72

Warning for Your Safety

The system designer and user have the sole responsibility to select products suitable for their special application requirements to ensure the proper installation. Operation and maintenance of the product. Application details, material compatibility and product ratings should all be considered in the individual selection. Improper selection or use of product can cause property damage or personal injury. Kurat accepts no liability for any improper selection, installation, operation or maintenance.